

W:\WE-C\RIDGECREST, CITY OF\13094 - RIDGECREST - PINNEY POOL\900-PS&E\901-PLANS\PL-01-TITLE.DWG 6/14/2024 1:47:26 PM

GENERAL CONSTRUCTION NOTES:

1. ALL WORK SHOWN HEREON SHALL BE CONSTRUCTED IN ACCORDANCE WITH THE STANDARD SPECIFICATIONS OF THE CALIFORNIA DEPARTMENT OF TRANSPORTATION, CURRENT EDITION.

2. THE CONTRACTOR IS REQUIRED TO TAKE DUE PRECAUTIONARY MEASURES TO PROTECT THE UTILITIES OR SUBSTRUCTURES FOUND AT THE SITE. IT SHALL BE THE CONTRACTOR'S RESPONSIBILITY TO NOTIFY THE OWNERS OF THE UTILITIES OR SUBSTRUCTRES CONCERNED BEFORE STARTING WORK. (72-HOURS NOTICE REQUIRED.) PRIOR TO CONSTRUCTION, THE CONTRACTOR SHALL CONTACT UNDERGROUND SERVICE ALERT (USA) TOLL FREE AT (800) 422-4133.

3. PRIOR TO BEGINNING OF CONSTRUCTION, THE CONTRACTOR SHALL SUBMIT A TRAFFIC CONTROL PLAN FOR DISRUPTIVE STREET WORK, INCLUDING CONSTRUCTION SCHEDULE - SUBJECT TO APPROVAL BY THE ENGINEER. MINIMUM REQUIREMENTS ARE STATED IN THE SPECIFICATIONS. CONSTRUCTION WARNING DEVICES, SIGNS, ETC., SHALL CONFORM WITH CURRENT EDITION CALIFORNIA MANUAL ON UNIFORM TRAFFIC CONTROL DEVICES.

4. CONTRACTOR SHALL PROTECT ALL EXISTING PROPERTIES FROM DAMAGE IN ACCORDANCE WITH SECTION 5-1.36 OF THE STANDARD SPECIFICATIONS AND THE PROJECT'S SPECIAL PROVISIONS.

5. SPECIFIC CONSTRUCTION STORAGE SITES, OTHER THAN AREAS CURRENTLY UNDER CONSTRUCTION FOR THIS CONTRACT, ARE NOT AVAILABLE. CONTRACTOR SHALL OBTAIN PRIOR PERMISSION FROM PROPERTY OWNER FOR ALL SITES ON PRIVATE PROPERTY SUBJECT TO ENGINEER'S APPROVAL.
6. EXCEPT WHERE DIRECTED OTHERWISE BY THE PLANS, SPECIFICATIONS, OR THE ENGINEER, CONTRACTOR SHALL REPLACE EXISTING TRAFFIC STRIPING AND MARKINGS IN KIND, TO THE SATISFACTION OF THE CITY ENGINEER.

7. NO STORAGE OR STAGING OF CREWS, EQUIPMENT OR MATERIALS WILL BE ALLOWED ON CITY STREETS.

8. CONTRACTOR SHALL PERFORM WATER FLOW TESTING OF RECONSTRUCTED SPANDRELS, CROSS GUTTERS, AND CURB AND GUTTER TO DEMONSTRATE NO PONDING.

9. CONTRACTOR SHALL NOTIFY EACH MOBILE HOME PARK RESIDENT, HOME OWNER, OR BUSINESS OF WORK SCHEDULE WITH AN APPROVED NOTE 3 DAYS IN ADVANCE OF EACH MAJOR CONSTRUCTION TASK

10. CONTRACTOR SHALL NOTIFY POLICE, FIRE, AMBULANCE, CITY TRANSIT, SCHOOL BUS, USPS, AND TRASH SERVICE OF EACH MAJOR CONSTRUCTION TASK.

11. CONTRACTOR'S SURVEYOR SHALL SURVEY, STATION, AND RECORD CENTERLINE ELEVATIONS AND LANE CENTERLINE ELEVATIONS. THE CONTRACTOR'S SURVEYOR SHALL THEN SET BLUE TOPS FOR THE NEW FINISH SURFACE ELEVATIONS FOR THE CENTERLINE AND LANE CENTERLINES PER TYPICAL STREET SECTION DETAILS.

UTILITY CONTACT LIST

City of Ridgecrest
Attn.: Les Wood
100 W. California Ave
Ridgecrest, CA 93555
(760) 382-8482

City of Ridgecrest Sanitary Sewer(CRS)
Attn.: Jim Humphrey
100 W. California Ave
Ridgecrest, CA 93555
(760) 446-4631

MediaCom
Attn.: Shawn Bell
555 S. China Lake Blvd
Ridgecrest, CA 93555
(951) 458-9902
Cell: (951) 634-8145

Southern California Edison Co.(SCE)
Attn.: Gary Gonzales
510 China Lake Blvd
Ridgecrest, CA 93555
(800) 611-1911

Pacific Gas & Electric (PG&E)
Attn.: Matthew Conners
4101 Wible Road
Bakersfield, CA 93313
(800) 743-5000
(661) 437-8701

Indian Wells Valley Water District (IWVWD)
Attn.: Jason Lillion
500 W. Ridgecrest Blvd
Ridgecrest, CA 93555
(760) 382-5570

Searles Valley Minerals
Attn.: Dipti Barari
13200 Main St.
Trona, CA 93562
(760) 372-2568

Frontier
Attn.: Stephen McDonald
520 S. China Lake Blvd
Ridgecrest, CA 93555
(805) 376-3766

Inyo Networks
Attn.: Joy Padilla
873 N. Main St, Suite 223
Bishop, CA 93514
(760) 551-8234
(888) 704-6872

Race Communications
1170 Unit C, E Tehachapi Blvd,
Tehachapi, CA 93561
(877) 722-3833

CITY OF RIDGECREST
PINNEY POOL
DEMOLITION

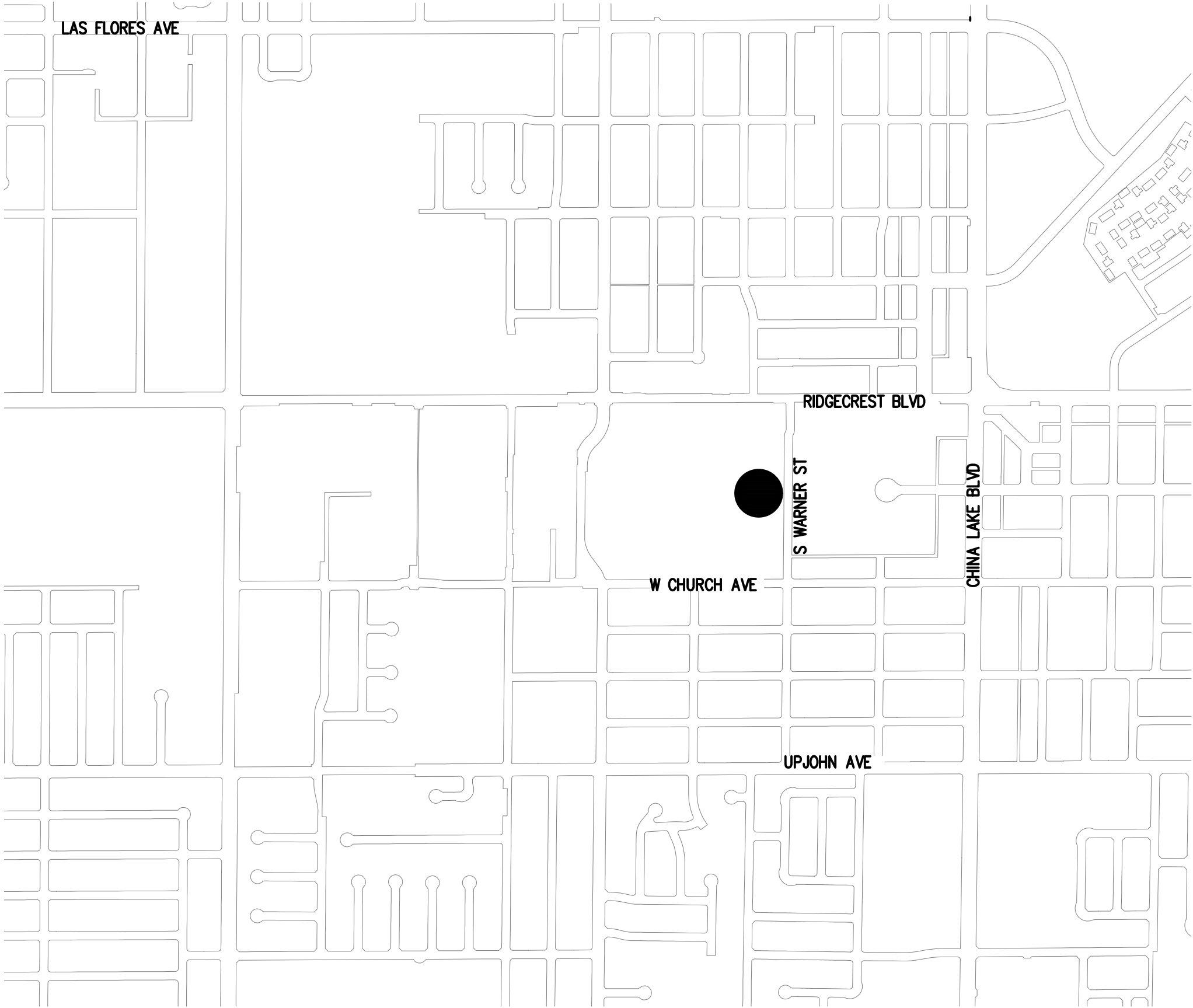

LOCATION MAP

NOT TO SCALE

PROJECT LOCATION

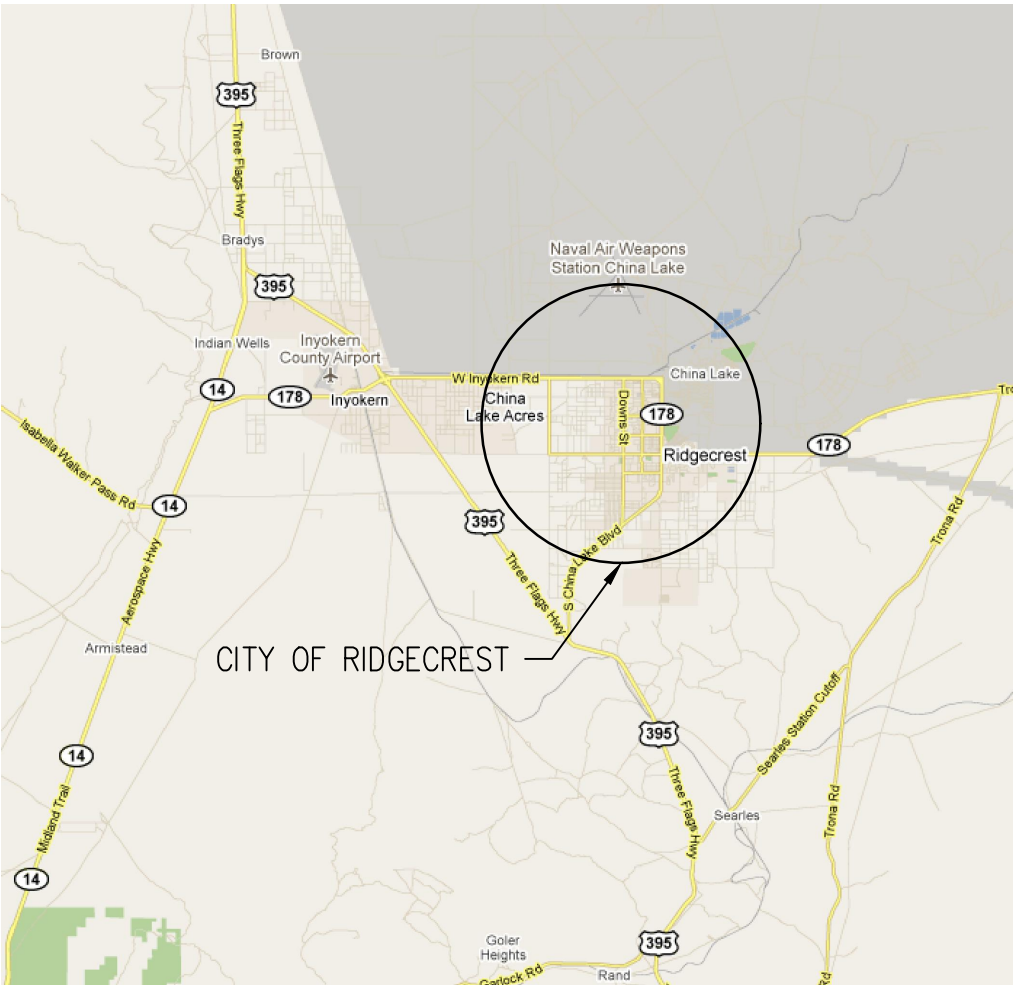

VICINITY MAP

NOT TO SCALE

SHEET INDEX:

SHEET 1 TITLE SHEET
SHEET 2 DEMO-CITY HALL

ABBREVIATIONS

AB	AGGREGATE BASE
AC	ASPHALT CONCRETE
AP	ANGLE POINT
ARHM	ASPHALT RUBBER HOT MIX
BC	BEGIN CURVE
BCR	BEGIN CURB RETURN
BEG.	BEGIN
BVC	BEGIN VERTICAL CURVE
BW	BACK OF WALK
BX	BOTTOM OF X
C&G	CURB AND GUTTER
CAB	CRUSHED AGGREGATE BASE
CB	CATCH BASIN
C/CL	CENTERLINE
CF	CURB FACE
CLF	CHAIN LINK FENCE
CLR	CLEAR
CMU	CONCRETE MASONRY UNIT
CONC	CONCRETE
COND	CONDUIT
CONST	CONSTRUCTION
CPC	CALIFORNIA PLUMBING CODE
CRS	CITY OF RIDGECREST SEWER
DI	DUCTILE IRON
DWY	DRIVEWAY
DWG	DRAWING
EC	END CURVE
ECR	END CURB RETURN
EG	EDGE OF GUTTER
ELEV	ELEVATION
E'LY	EASTERLY
EP	EDGE OF PAVEMENT
EVC	END VERTICAL CURVE
EX/EXIST	EXISTING
FDR	FULL DEPTH RECLAMATION
FF	FINISHED FLOOR
FG	FINISHED GRADE
FH	FIRE HYDRANT
FL/FL	FLOWLINE
FS	FINISHED SURFACE
FT	FEET
GL	GUTTER LIP
GB	GRADE BREAK
HB	HOSE BIBB
HDPE	HIGH DENSITY POLYETHYLENE
HMA	HOT MIX ASPHALT
HP	HIGH POINT
HTF	HIGH TENSILE FIBER
INT	INTERSECTION
INV	INVERT
L	LENGTH
LF	LINEAR FEET
LIP	LIP OF GUTTER
LNSP	LANDSCAPE
LT	LEFT
MAX	MAXIMUM
MH	MANHOLE
MIN	MINIMUM
MON	MONUMENT
N	NORTH
NIC	NOT IN CONTRACT
N'LY	NORTHERLY
NO	NUMBER
NTS	NOT TO SCALE
OC	ON CENTER
OG	ORIGINAL GROUND
OH	OVERHEAD
PB	PULLBOX
PI	POINT OF INTERSECTION
PCC	PORTLAND CEMENT CONCRETE
PMB	PROCESSED MISCELLANEOUS BASE
POC	POINT OF CONNECTION
POT	POINT ON TANGENT
PP	POWER POLE
PRC	POINT OF REVERSE CURVE
PROP	PROPOSED
PRVC	POINT OF REVERSE VERTICAL CURVE
PT	POINT
PVC	POLYVINYL CHLORIDE
PVMT	PAVEMENT
R	RATE, RADIUS
RC	RELATIVE COMPACTION
RCP	REINFORCED CONCRETE PIPE
REQ'D	REQUIRED
RT	RIGHT
RW,R/W	RIGHT-OF-WAY
S	SLOPE
S'LY	SOUTHERLY
SCE	SOUTHERN CALIFORNIA EDISON
SCH	SCHEDULE
SCO	SEWER CLEANOUT
SDMH	STORM DRAIN MANHOLE
SDWK	SIDEWALK
ST	STREET
STA	STATION
STD	STANDARD
ST GR	STRAIGHT GRADE
TC	TOP OF CURB
TG	TOP OF GRATE
TOP	TOP OF PLATFORM
TR	TOP OF RAIL
TS	TRAFFIC SIGNAL
TW	TOP OF WALL
TX	TOP OF X
TYP	TYPICAL
V	DEPTH
VAR	VARIES
VCP	VITRIFIED CLAY PIPE
W	WIDTH, WEST
W'LY	WESTERLY
WM	WATER METER
W&V	WASTE AND VENT

REFERENCES

NO.	DESCRIPTION	APP.	DATE



APPROVED BY: CITY OF RIDGECREST

TRAVIS REED, P.E. R.C.E. 93828 DATE
PUBLIC WORKS DIRECTOR
PREPARED UNDER THE SUPERVISION OF:
Matthew Crim 6/17/2024
MATTHEW CRIM, P.E. R.C.E. 94393 DATE

PLANS PREPARED BY:

WILLDAN
374 POLI STREET, SUITE 101
VENTURA, CALIFORNIA 93001
(805) 653-6597

CITY OF RIDGECREST
PUBLIC WORKS DEPARTMENT
100 W. CALIFORNIA AVENUE
RIDGECREST, CA. 93555
(760) 499-5000

CITY OF RIDGECREST

PINNEY POOL DEMOLITION

TITLE SHEET

DATE: 6/17/2024
SCALE: AS-NOTED
PROJECT NO.
DRAWN BY: RGS
CHECKED BY: MAC
SHEET: 1 OF 2

100% SUBMITTAL - NOT FOR CONSTRUCTION

W:\WE-CAL\RIDGECREST, CITY OF\13094 - RIDGECREST PINNEY POOL\900-PS&E\901-PLANS\PL-DEM-CITY HALL.DWG 6/17/2024 2:27:50 PM

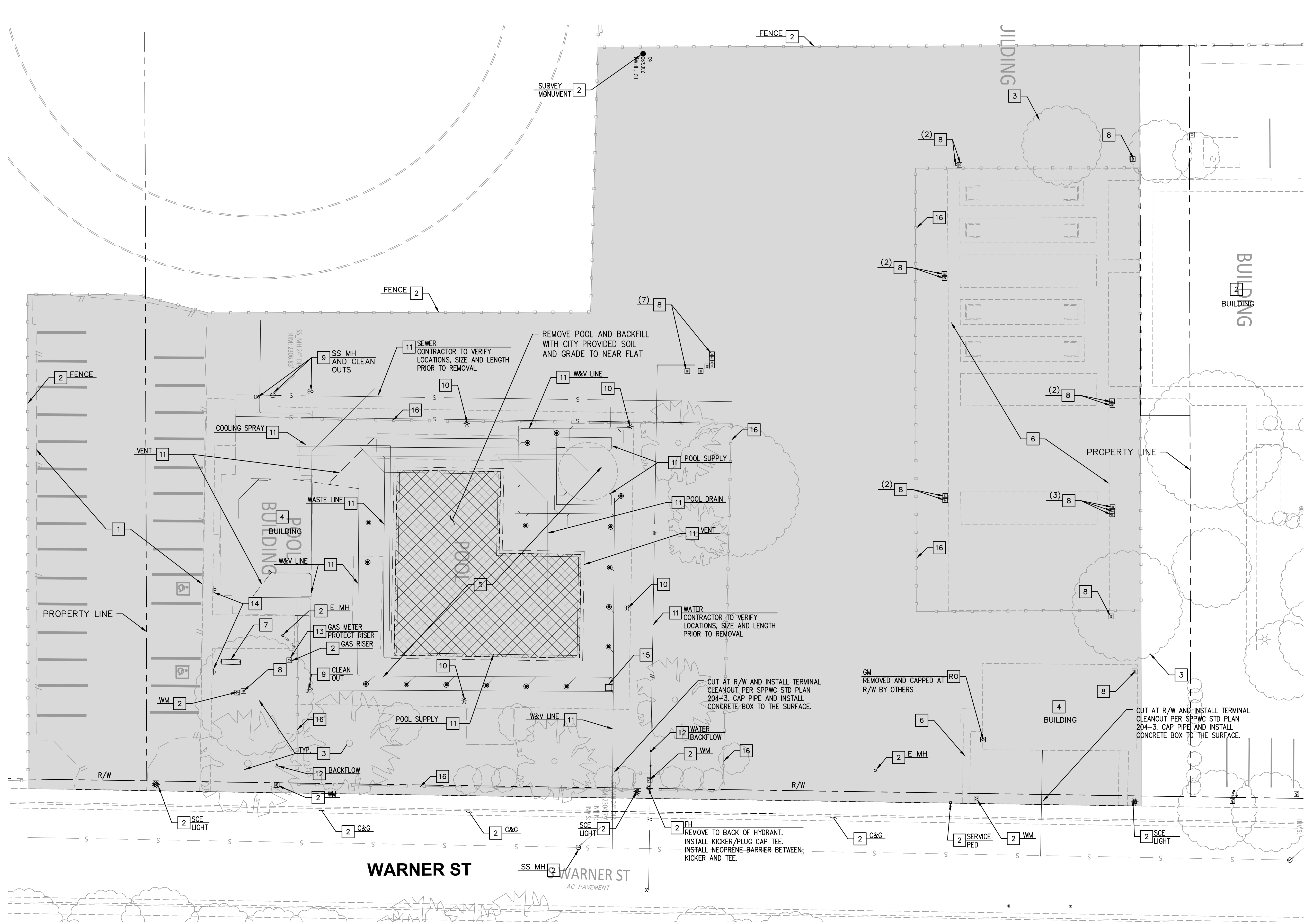

DEMOLITION NOTES

- 1 REMOVE AC
- 2 PROTECT IN PLACE
- 3 REMOVE/RELOCATE EXISTING TREES, CONTRACTOR TO COORDINATE WITH OWNER
- 4 REMOVE EXISTING BUILDING
- 5 REMOVE POOL, POOL DECK, POOL BUILDING, AND ALL DRAINS AND MECHANICAL EQUIPMENT
- 6 REMOVE EXISTING SIDEWALK
- 7 REMOVE EXISTING BIKE RACK
- 8 REMOVE EXISTING SPRINKLER BOXES
- 9 REMOVE MANHOLE AND CLEAN OUTS
- 10 REMOVE LIGHT POLE
- 11 REMOVE UTILITY LINE
- 12 REMOVE WATER VALVE, METER FIRE HYDRANT OR BACKFLOW
- 13 REMOVE GAS VALVE OR METER
- 14 REMOVE SIGN
- 15 REMOVE VAULT
- 16 REMOVE FENCE
- RO REMOVED BY OTHER

LEGEND

- | | |
|--|--------------------------|
| | AREA TO BE DEMOLISHED |
| | REMOVE POOL AND BACKFILL |
| | SIGN |
| | POWER POLE |
| | SPRINKLER BOX |
| | WATER METER |
| | FIRE HYDRANT |
| | GAS METER |
| | GAS VALVE |
| | SEWER MANHOLE |
| | POOL DRAIN |

GENERAL NOTES

1. ALL FENCES, ASPHALT PAVEMENT, CURBS, BUILDINGS, UTILITIES, POSTS, CONCRETE WALKWAYS, FOUNDATIONS, TREES, SHRUBS, IRRIGATION AND LANDSCAPE WITHIN LIMITS OF REMOVAL ARE TO BE REMOVED, UNLESS OTHERWISE NOTED.
2. CUT AND CAP ALL ONSITE UTILITIES AT PROPERTY LINE. REMOVE PORTIONS OF UTILITIES WITHIN RIGHT OF WAY
3. PROJECT IN PLACE ALL UTILITIES, SIGNAGE, TS, IN R/W AREA UNLESS OTHERWISE NOTED.
4. CONTRACTOR TO COORDINATE WITH SCE FOR REMOVAL OF WIRES BETWEEN TRANSFORMER AND MAIN PANEL
5. CONTRACTOR SHALL COORDINATE WITH CITY STAFF AND PG&E FOR GAS METER/LINE REMOVALS. CONTRACTOR SHALL PROTECT ALL GAS LINE APPURTENANCES IN PLACE FROM THE METER TO THE STREET UNLESS DIRECTED OTHERWISE BY PG&E OR THE CITY.
6. ASBESTOS AND LEAD FOUND ON SITE. CONTRACTOR SHALL TAKE ALL REQUIRED PRECAUTIONS AS REQUIRED BY OSHA. CONTRACTORS ATTENTION IS DIRECTED TO THE SPECIFICATIONS FOR MORE DETAILS.

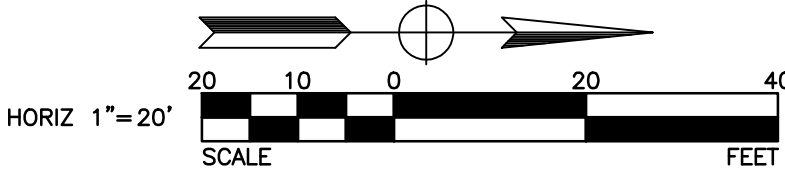

Know what's below.
Call before you dig.

REFERENCES			
NO.	DESCRIPTION	APP.	DATE



APPROVED BY: CITY OF RIDGECREST

TRAVIS REED, P.E. R.C.E. 93828 DATE
PUBLIC WORKS DIRECTOR

PREPARED UNDER THE SUPERVISION OF:
Matthew Crim 6/17/2024
MATTHEW CRIM, P.E. R.C.E. 94393 DATE

PLANS PREPARED BY:

WILLDAN

374 POLI STREET, SUITE 101
VENTURA, CALIFORNIA 93001
(805) 653-6597

CITY OF RIDGECREST
PUBLIC WORKS DEPARTMENT
100 W. CALIFORNIA AVENUE
RIDGECREST, CA. 93555
(760) 499-5000

CITY OF RIDGECREST

PINNEY POOL DEMOLITION

DEMOLITION PLAN

DATE: 6/17/2024
SCALE: AS-NOTED
PROJECT NO.
DRAWN BY: RGS
CHECKED BY: MAC
SHEET: 2 OF 2

100% SUBMITTAL - NOT FOR CONSTRUCTION